



SIGNAL ISOLATION CONVERTER MSC/WSC/FSC SERIES

GENERAL INFORMATION

The signal isolation converter Model MSC/WSC/FSC accepts standard and non-standard process signals and provides an isolated, proportional DC output.



● MODEL : MSC (1OUT)



● MODEL : WSC (2OUT)



● MODEL : FSC (3OUT~5OUT)

MODEL MSC
WSC
FSC(3~5OUT)

INPUT SIGNAL

- | | |
|------------------|------------------|
| 1. 0 ~ 10mV | A. 4 ~ 20mA |
| 2. 0 ~ 100mV | B. 2 ~ 10mA |
| 3. 0 ~ 1V | C. 1 ~ 5mA |
| 4. 0 ~ 5V | D. 0 ~ 20mA |
| 5. 0 ~ 10V | E. 0 ~ 10mA |
| 6. 1 ~ 5V | F. 0 ~ 1mA |
| 0. OTHER VOLTAGE | Z. OTHER CURRENT |

OUTPUT SIGNAL

- | | |
|------------------|------------------|
| 1. 0 ~ 10mV | A. 4 ~ 20mA |
| 2. 0 ~ 100mV | B. 2 ~ 10mA |
| 3. 0 ~ 1V | C. 1 ~ 5mA |
| 4. 0 ~ 5V | D. 0 ~ 20mA |
| 5. 0 ~ 10V | E. 0 ~ 10mA |
| 6. 1 ~ 5V | F. 0 ~ 1mA |
| 0. OTHER VOLTAGE | Z. OTHER CURRENT |

POWER SUPPLY

- AC 110/220V ±10%
- DC 24V (OPTION)

SPECIFICATIONS

ITEM	SPECIFICATIONS
INPUT	DC VOLTAGE SIGNAL DC CURRENT SIGNAL
OUTPUT	DC VOLTAGE OR DC CURRENT SIGNAL
ACCURACY	±0.1% of F.S
LINEARITY	±0.1% of F.S
REPEATABILITY	±0.1% of F.S
RESPONSE TIME	LESS THAN 0.5sec(0 ~ 90%)
INSULATION RESISTANCE	GREATER THAN 100M ohm (DC 500V)
DIELECTRIC STRENGTH	INPUT-POWER AC 1000V INPUT-OUTPUT AC 1000V (1 MIN) INPUT-GND AC 1000V
AMBIENT TEMPERATURE	-5 ~ 60°C
HUMIDITY	LESS THAN 90% RH

BLOCK DIAGRAM & CONNECTIONS

□ MODEL MSC

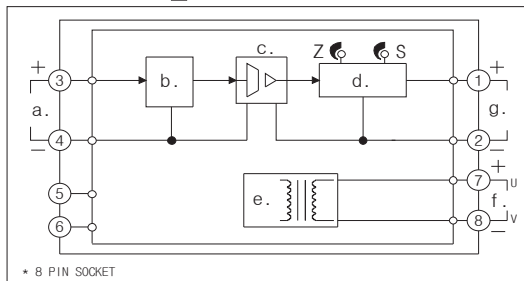

□ MODEL WSC

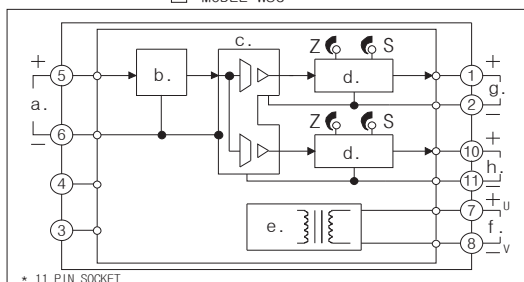

- INPUT
- LOW DRIFT AMPLIFIER
- ISOLATION
- OUTPUT DRIVER
- POWER
- POWER SOURCE
- POWER SOURCE
- OUTPUT 1
- OUTPUT 2
- OUTPUT 3
- OUTPUT 4
- OUTPUT 5

□ MODEL FSC

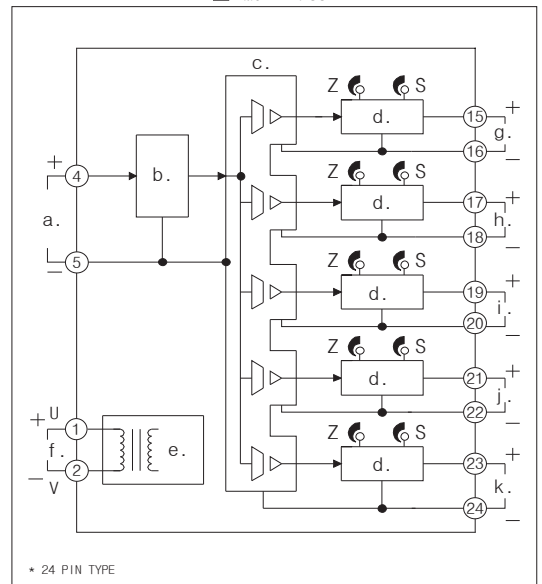

GENERAL SPECIFICATIONS

Construction : plug-in(MSC,WSC)
wall mounting(FSC)

Housing material : ABS plastic(black)

Adjustments : zero and span ; $\pm 5\%$

INSTALLATION

DC : 24V $\pm 10\%$, 100mA(ripple 10% p-p max)

AC : rating(100 ~ 240V) $\pm 10\%$, 50/60Hz 4VA

Mounting : wall or DIN rail

INPUT SIGNAL SPECIFICATIONS

Input voltage signal : $-300 \sim 300V$ DC

Input voltage impedance : 1Mohm or more

Input current signal : 50mA DC max

OUTPUT SIGNAL SPECIFICATIONS

Output voltage : 12V DC max

Output current : 30mA DC max

DC voltage

OUTPUT	LOAD RESISTANCE	IMPEDANCE
0-10mV	10K Ω or more	10 Ω or less
0-100mV	100K Ω or more	100 Ω or less
0-1V	1K Ω or more	1 Ω or less
0-10V	10K Ω or more	
0-5V	5K Ω or more	
1-5V		

DC current

OUTPUT	LOAD RESISTANCE	IMPEDANCE
4-20mA	0 - 600 Ω	5M Ω or more
2-10mA	0 - 1200 Ω	
1-5mA	0 - 2400 Ω	
0-20mA	0 - 600 Ω	
0-16mA	0 - 750 Ω	
0-10mA	0 - 1200 Ω	
0-1mA	0 - 12K Ω	

EXTERNAL DIMENSION, TERMINAL ARRANGEMENT

8 PIN SOCKET DIMENSIONS

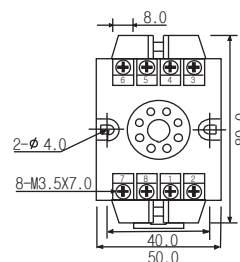
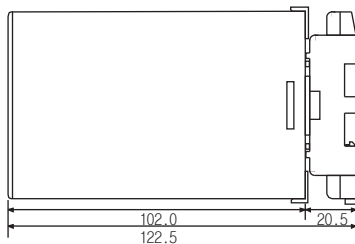
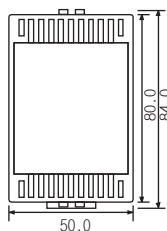

11 PIN SOCKET DIMENSIONS

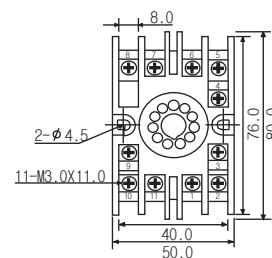
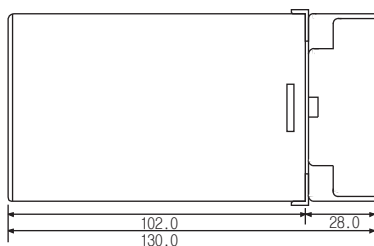
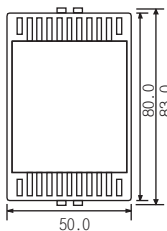

F-TYPE DIMENSIONS (24 PIN)

